

A

B

C

D

E

F

修订 REV	标记 MARK	修改摘要 REVISION DESCRIPTION	签名 SIGNATURE	日期 DATE
AO		NEW DWG	WANG	2016-03-12

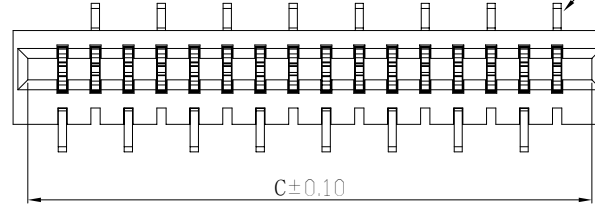
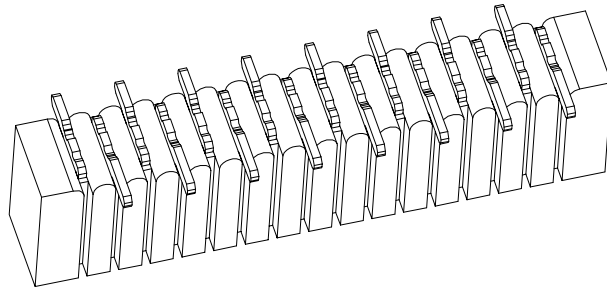

定义正脚位

性能:

额定电流: 0.5A

额定电压: 50V

耐电压: 500V

接触电阻: 30mΩ

绝缘电阻: 800MΩ

工作温度: -20℃~+85℃

塑件(材质): LCP BLACK, UL94V-0

插簧(材质): 磷青铜, 镀锡/镀金

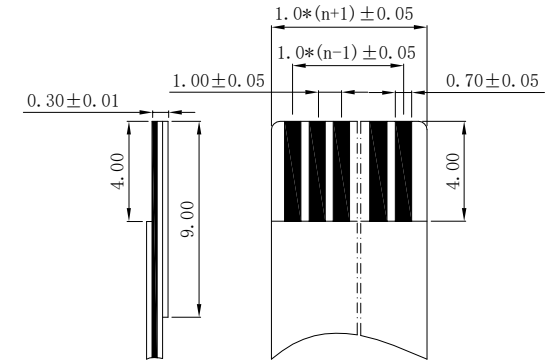
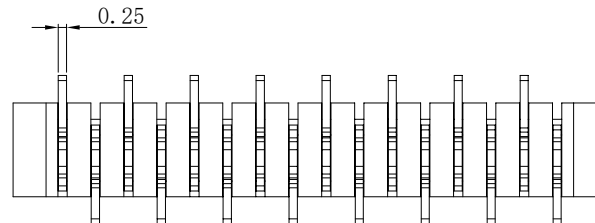
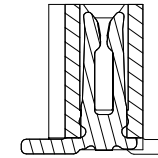
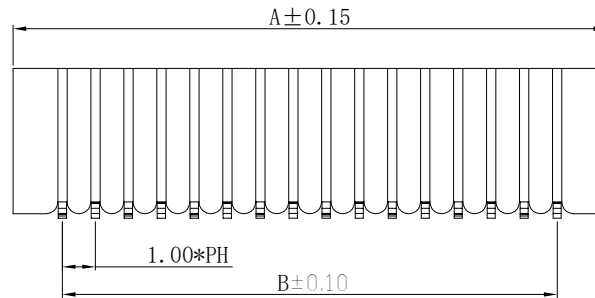
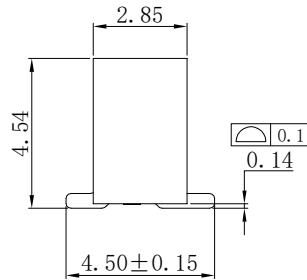

适用扁平电缆

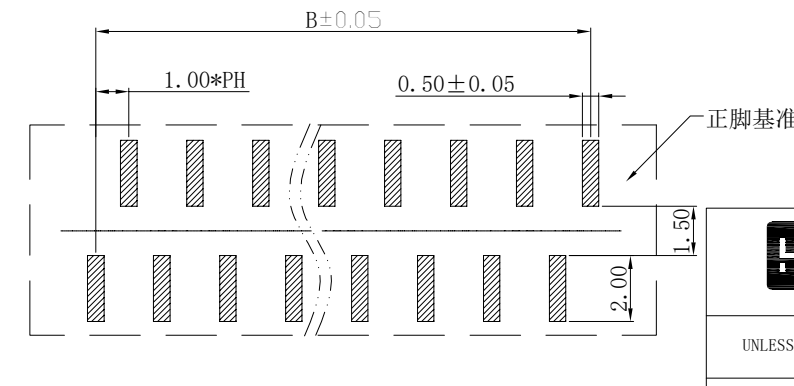

PCB LAYOUT



深圳市华德共创科技有限公司

Shenzhen Huade co-create Technology Co., LTD

电话: 0755-27129737

传真: 0755-29940187

-TOLERANCES-
UNLESS OTHERWISE SPECIFIED
公差参数表



TITLE:

产品名称: 1.0mm FPC(双面接) 立贴正脚

X.X ±0.30 X.X* ±3°

APPD:
核准: XIE

PART NO:

产品编号: 1.0-B-nPB

X.XX ±0.20 X.XX* ±2°

CHECK:
校对: WANG

DATE

SCALE

UNIT

CODE NUMBER

X.XXX ±0.10 X.XXX* ±1°

DRAW:
绘图: WANG

2014-03-16

1:1

mm

A001

A

B

C

D

E

F