

Specifications

- Current rating: 4A AC, DC
- Voltage rating: 125V AC, DC
- Temperature range: -25°C ~ +85°C
- Contact resistance: 10mΩ Max.
- Insulation resistance: 1000MΩ Min.
- Withstanding voltage: 1000V AC/minute
- *Compliant with RoHS and REACH*
- *Meet the HF/Halogen Free, need to customize*
- *Contact HDGC for details*

Assembly layout

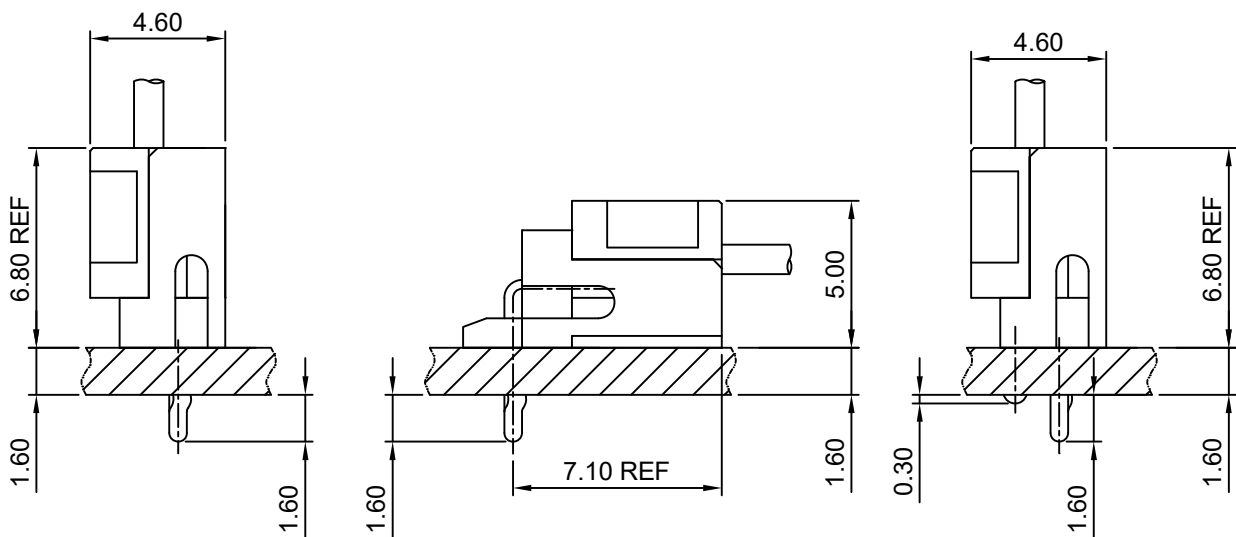



HDGC2007 Series 2.00mm (.079") Pitch Wire to Board Connector

HDGC2007-T

2.00mm pitch Crimp Terminal

Reference Informations:

*Used in HDGC2007H-XP series Housing

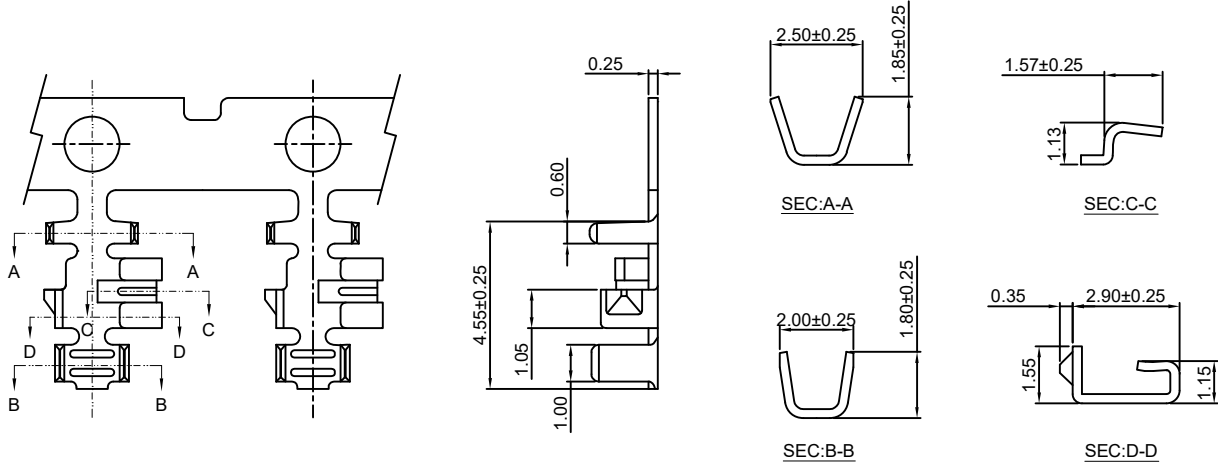

Ordering information & Specifications:

Unit:mm

Part NO.	Wire Range	Insulation O.D.	Material	Finish	Qty/reel
HDGC2007-TP	AWG#22-#26	1.50mm(max)	Phosphor Bronze	Tin over Nickel	10,000 PCS
HDGC2007-GP	AWG#22-#26	1.50mm(max)	Phosphor Bronze	Gold over Nickel	10,000 PCS

Optional Gold plating available but MOQ requested

HDGC2007H-XP

2.00mm pitch Housing

Reference Informations:

*Material:Nylon 66,UL94V-0

*Suitable HDGC2007-T series Terminal

*Mates with HDGC2007WV,WR,WR-S,WR-S-F-XP, HDGC2007WVD,WRD-XP series Wafer

*Color:White

Ordering Information:

HDGC2007H-XP - *** - **
1 2 3

1.Part No.

2.Material:

(Blank):Nylon 66,UL94V-0

GWT :Nylon 66,UL94V-0 GWT 750 °C

3.Color:

(Blank):White

BK:Black

BL:Blue

YL:Yellow

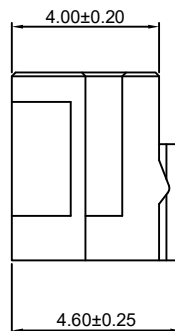
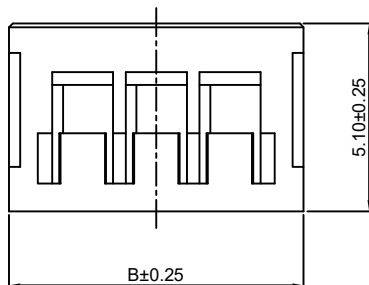
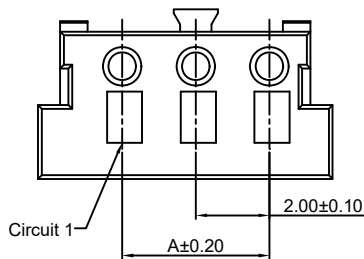
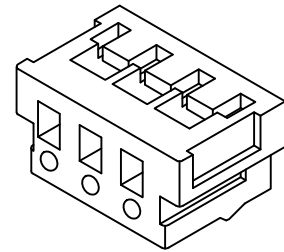

Ordering Information & Dimensions:

PART NO.	Dimensions	
	A	B
2P	2.00	5.60
3P	4.00	7.60
4P	6.00	9.60
5P	8.00	11.60
6P	10.00	13.60
7P	12.00	15.60
8P	14.00	17.60
9P	16.00	19.60
10P	18.00	21.60
11P	20.00	23.60
12P	22.00	25.60
13P	24.00	27.60
14P	26.00	29.60
15P	28.00	31.60

Unit: mm



HDGC2007 Series 2.00mm (.079") Pitch Wire to Board Connector

HDGC2007HD-XP

2.00mm pitch IDC Housing

Reference Informations:

*Material:

Terminal: Phosphor Bronze/Tin over Nickel
Housing: Nylon 66, UL94V-0

*Mates with HDGC2007WV, WR, WR-S, WR-S-F-XP, HDGC2007WVD, WRD-XP series Wafer

*Color: White

Ordering Information:

HDGC2007HD-XP - *** - **
1 2 3

1. Part No.

2. Material:

(Blank): Nylon 66, UL94V-0

GWT : Nylon 66, UL94V-0 GWT 750 °C

3. Color:

(Blank): White

BK: Black

BL: Blue

YL: Yellow

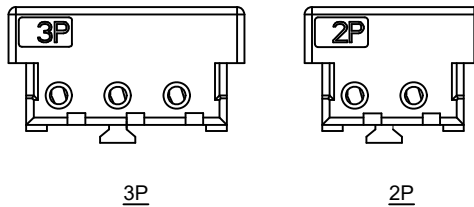
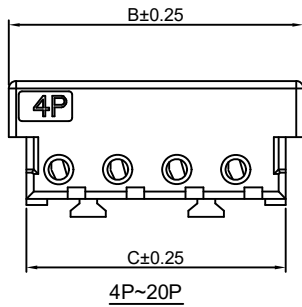
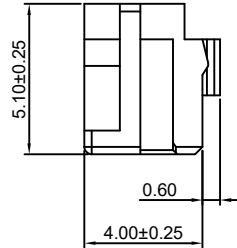
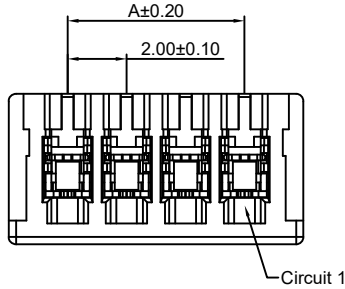

Ordering Information & Dimensions:

PART NO.	Dimensions		
	A	B	C
2P	2.00	6.00	4.80
3P	4.00	8.00	6.80
4P	6.00	10.00	8.80
5P	8.00	12.00	10.80
6P	10.00	14.00	12.80
7P	12.00	16.00	14.80
8P	14.00	18.00	16.80
9P	16.00	20.00	18.80
10P	18.00	22.00	20.80
11P	20.00	24.00	22.80
12P	22.00	26.00	24.80
13P	24.00	28.00	26.80
14P	26.00	30.00	28.80
15P	28.00	32.00	30.80

Unit: mm

HDGC2007WV-XP

2.00mm pitch 180° Wafer

Reference Informations:

*Material: Pin: Brass/Tin over Nickel

Insulator: Nylon 66, UL94V-0

*Mates with HDGC2007H, HD-XP series Housing

*Color: White

Ordering Information:

HDGC2007WV-XP - *** - **
1 2 3

1. Part No.

2. Material:

(Blank): Nylon 66, UL94V-0

GWT : Nylon 66, UL94V-0 GWT 750 °C

3. Color:

(Blank): White

BK: Black

BL: Blue

YL: Yellow

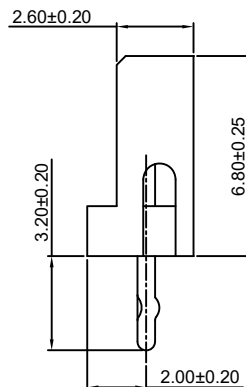
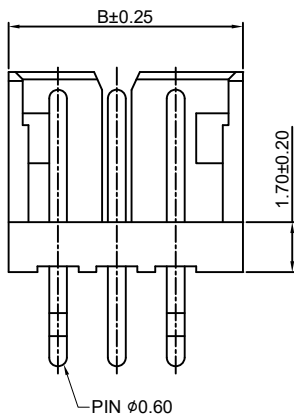
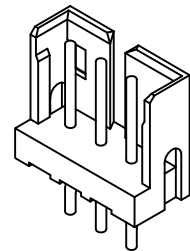
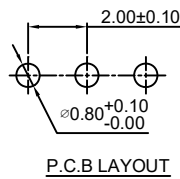
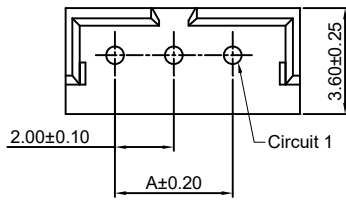

Ordering Information & Dimensions:

PART NO.	Dimensions	
	A	B
2P	2.00	5.96
3P	4.00	7.96
4P	6.00	9.96
5P	8.00	11.96
6P	10.00	13.96
7P	12.00	15.96
8P	14.00	17.96
9P	16.00	19.96
10P	18.00	21.96
11P	20.00	23.96
12P	22.00	25.96
13P	24.00	27.96
14P	26.00	29.96
15P	28.00	31.96

Unit: mm



HDGC2007 Series 2.00mm (.079") Pitch Wire to Board Connector

HDGC2007WR-XP

2.00mm pitch 90° Wafer

Reference Informations:

- *Material:Pin:Brass/Tin over Nickel
Insulator:Nylon 66,UL94V-0
- *Mates with HDGC2007H,HD-XP series Housing
- *Color:White

Ordering Information:
HDGC2007WR-XP - *** - **
1 2 3

- Part No.
- Material:
(Blank):Nylon 66,UL94V-0
GWT :Nylon 66,UL94V-0 GWT 750°C
- Color:
(Blank):White
BK:Black
BL:Blue
YL:Yellow

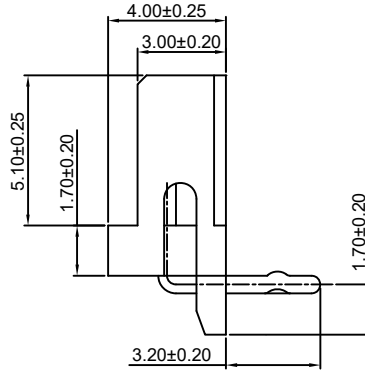
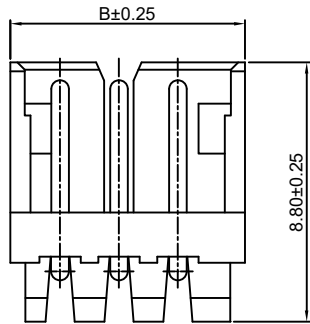
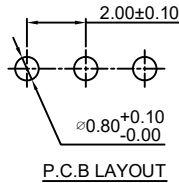
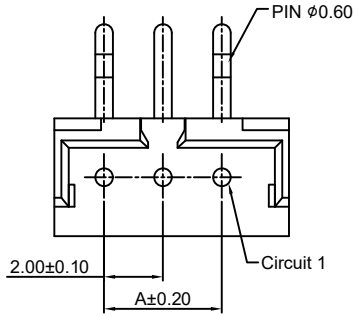
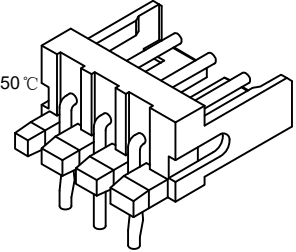

Ordering Information & Dimensions:

PART NO.	Dimensions	
	A	B
2P	2.00	5.96
3P	4.00	7.96
4P	6.00	9.96
5P	8.00	11.96
6P	10.00	13.96
7P	12.00	15.96
8P	14.00	17.96
9P	16.00	19.96
10P	18.00	21.96
11P	20.00	23.96
12P	22.00	25.96
13P	24.00	27.96
14P	26.00	29.96
15P	28.00	31.96

Unit: mm

HDGC2007WVD-XP

2.00mm pitch 180° Wafer

Reference Informations:

- *Material:Pin:Brass/Tin over Nickel
Insulator:Nylon 66,UL94V-0
- *Mates with HDGC2007H,HD-XP series Housing
- *Color:White

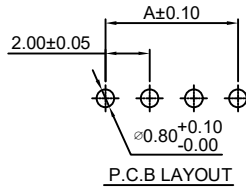

Ordering Information:
HDGC2007WVD-XP - *** - **
1 2 3

- Part No.
- Material:
(Blank):Nylon 66,UL94V-0
GWT :Nylon 66,UL94V-0 GWT 750°C
- Color:
(Blank):White
BK:Black
BL:Blue
YL:Yellow

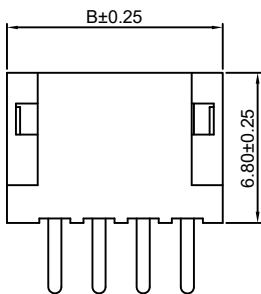
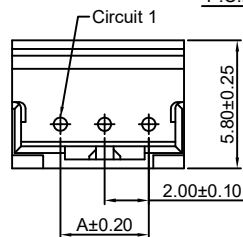
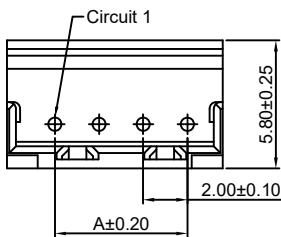
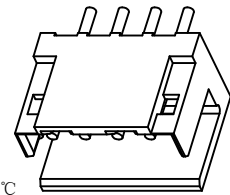

4P~15P

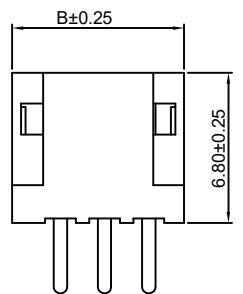

2P~3P

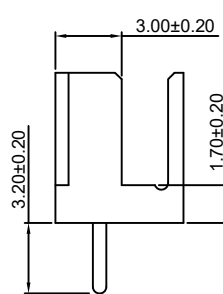

Ordering Information & Dimensions:

PART NO.	Dimensions	
	A	B
2P	2.00	5.80
3P	4.00	7.80
4P	6.00	9.80
5P	8.00	11.80
6P	10.00	13.80
7P	12.00	15.80
8P	14.00	17.80
9P	16.00	19.80
10P	18.00	21.80
11P	20.00	23.80
12P	22.00	25.80
13P	24.00	27.80
14P	26.00	29.80
15P	28.00	31.80

Unit: mm



HDGC2007 SERIES



HDGC2007 Series 2.00mm (.079") Pitch Wire to Board Connector

HDGC2007WRD-XP

2.00mm pitch 90° Wafer

Reference Informations:

- *Material: Pin: Brass/Tin over Nickel
Insulator: Nylon 66, UL94V-0
- *Mates with HDGC2007H, HD-XP series Housing
- *Color: White

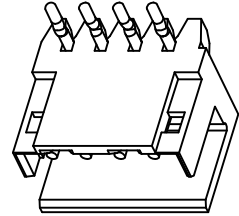
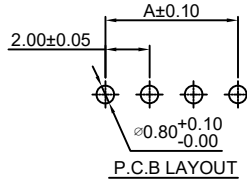

Ordering Information:
 HDGC2007WRD-XP - *** - **
 1 2 3

- Part No.
- Material:
(Blank): Nylon 66, UL94V-0
GWT : Nylon 66, UL94V-0 GWT 750 °C
- Color:
BK: Black
BL: Blue
YL: Yellow

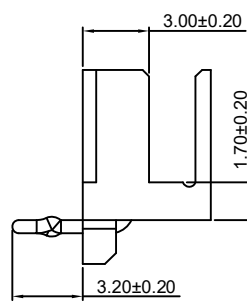
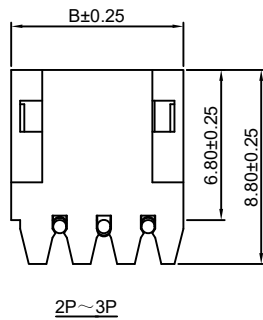
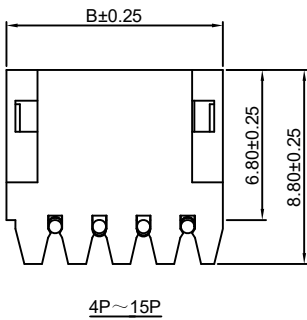
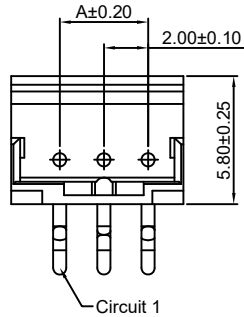
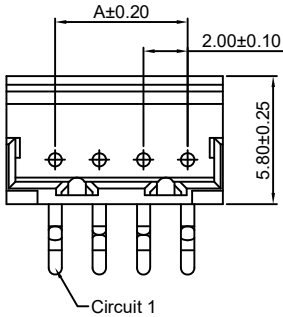

Ordering Information & Dimensions:

PART NO.	Dimensions	
	A	B
2P	2.00	5.80
3P	4.00	7.80
4P	6.00	9.80
5P	8.00	11.80
6P	10.00	13.80
7P	12.00	15.80
8P	14.00	17.80
9P	16.00	19.80
10P	18.00	21.80
11P	20.00	23.80
12P	22.00	25.80
13P	24.00	27.80
14P	26.00	29.80
15P	28.00	31.80

Unit: mm

HDGC2007WV-F-3P

2.00mm pitch 180° Wafer With Foot

Reference Informations:

- *Material: Pin: Brass/Tin over Nickel
Insulator: Nylon 66, UL94V-0
- *Mates with HDGC2007H, HD-3P series Housing
- *Color: White

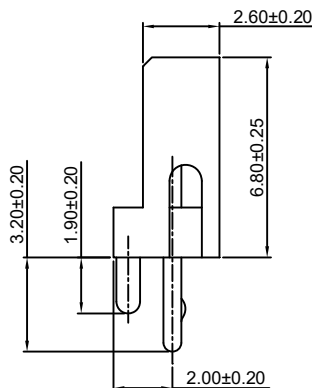
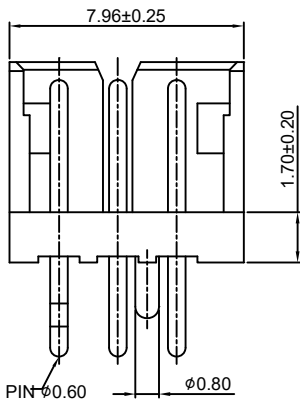
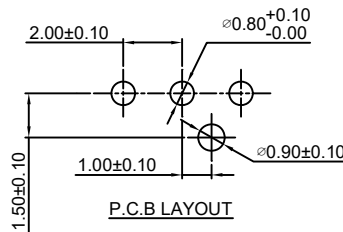
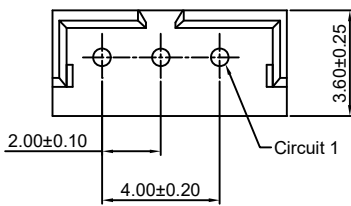

Ordering Information:
 HDGC2007WV-F-3P - *** - **
 1 2 3

- Part No.
- Material:
(Blank): Nylon 66, UL94V-0
GWT : Nylon 66, UL94V-0 GWT 750 °C
- Color:
(Blank): White
BK: Black
BL: Blue
YL: Yellow

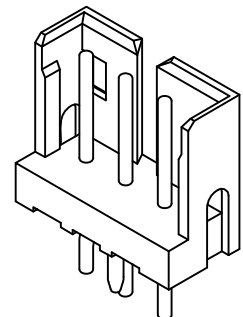

Unit: mm



HDGC2007 Series 2.00mm (.079") Pitch Wire to Board Connector

HDGC2007WR-S-XP

2.00mm pitch 90° Wafer - SMT TYPE

Reference Informations:

- *Material: Pin: Brass/Tin over Nickel
Insulator: Nylon 6T, UL94V-0
- *Mates with HDGC2007H, HD-XP series Housing
- *Color: Beige

Ordering Information:
 $\frac{\text{HDGC2007WR-S-XP}}{1} - \frac{\text{---}}{2} - \frac{\text{**}}{3}$

- 1. Part No.
- 2. Material:
(Blank): Nylon 66, UL94V-0
GWT : Nylon 66, UL94V-0 GWT 750 °C
- 3. Color:
(Blank): Beige
BK: Black
BL: Blue
YL: Yellow

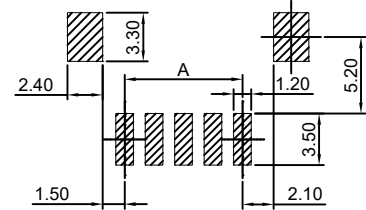
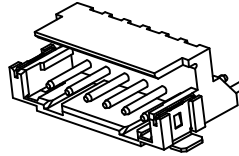
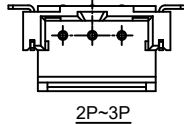
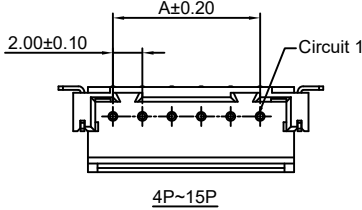

P.C.B LAYOUT

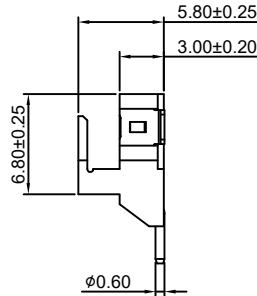
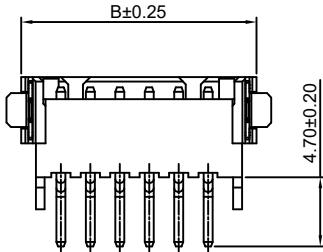

PART NO.	Dimensions	
	A	B
2P	2.00	8.00
3P	4.00	10.00
4P	6.00	12.00
5P	8.00	14.00
6P	10.00	16.00
7P	12.00	18.00
8P	14.00	20.00
9P	16.00	22.00
10P	18.00	24.00
11P	20.00	26.00
12P	22.00	28.00
13P	24.00	30.00
14P	26.00	32.00
15P	28.00	34.00

Unit: mm

HDGC2007WR-S-F-XP

2.00mm pitch 90° Wafer - SMT TYPE

Reference Informations:

- *Material: Pin: Brass/Tin over Nickel
Insulator: Nylon 6T, UL94V-0
- *Mates with HDGC2007H, HD-XP series Housing
- *Color: Beige

Ordering Information:
 $\frac{\text{HDGC2007WR-S-F-XP}}{1} - \frac{\text{---}}{2} - \frac{\text{**}}{3}$

- 1. Part No.
- 2. Material:
(Blank): Nylon 66, UL94V-0
GWT : Nylon 66, UL94V-0 GWT 750 °C
- 3. Color:
(Blank): Beige
BK: Black
BL: Blue
YL: Yellow

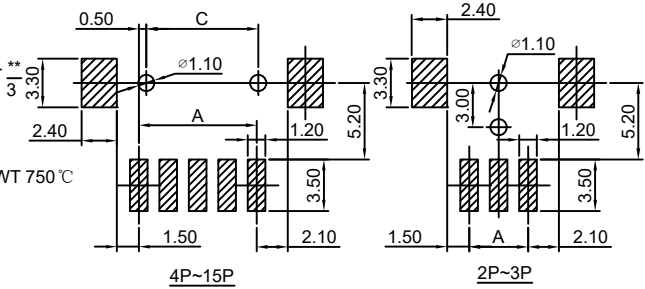
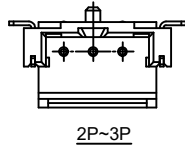
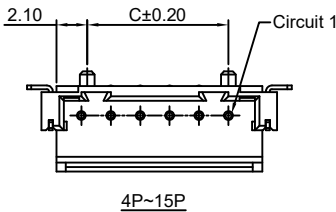

P.C.B LAYOUT

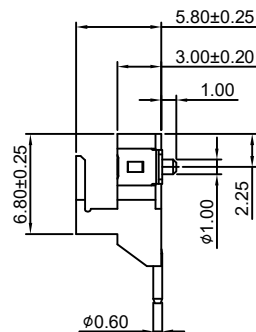
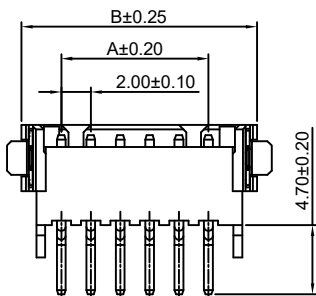

PART NO.	Dimensions		
	A	B	C
2P	2.00	8.00	---
3P	4.00	10.00	---
4P	6.00	12.00	5.60
5P	8.00	14.00	7.60
6P	10.00	16.00	9.60
7P	12.00	18.00	11.60
8P	14.00	20.00	13.60
9P	16.00	22.00	15.60
10P	18.00	24.00	17.60
11P	20.00	26.00	19.60
12P	22.00	28.00	21.60
13P	24.00	30.00	23.60
14P	26.00	32.00	25.60
15P	28.00	34.00	27.60

Unit: mm